

Lehman —
PIKE ✓

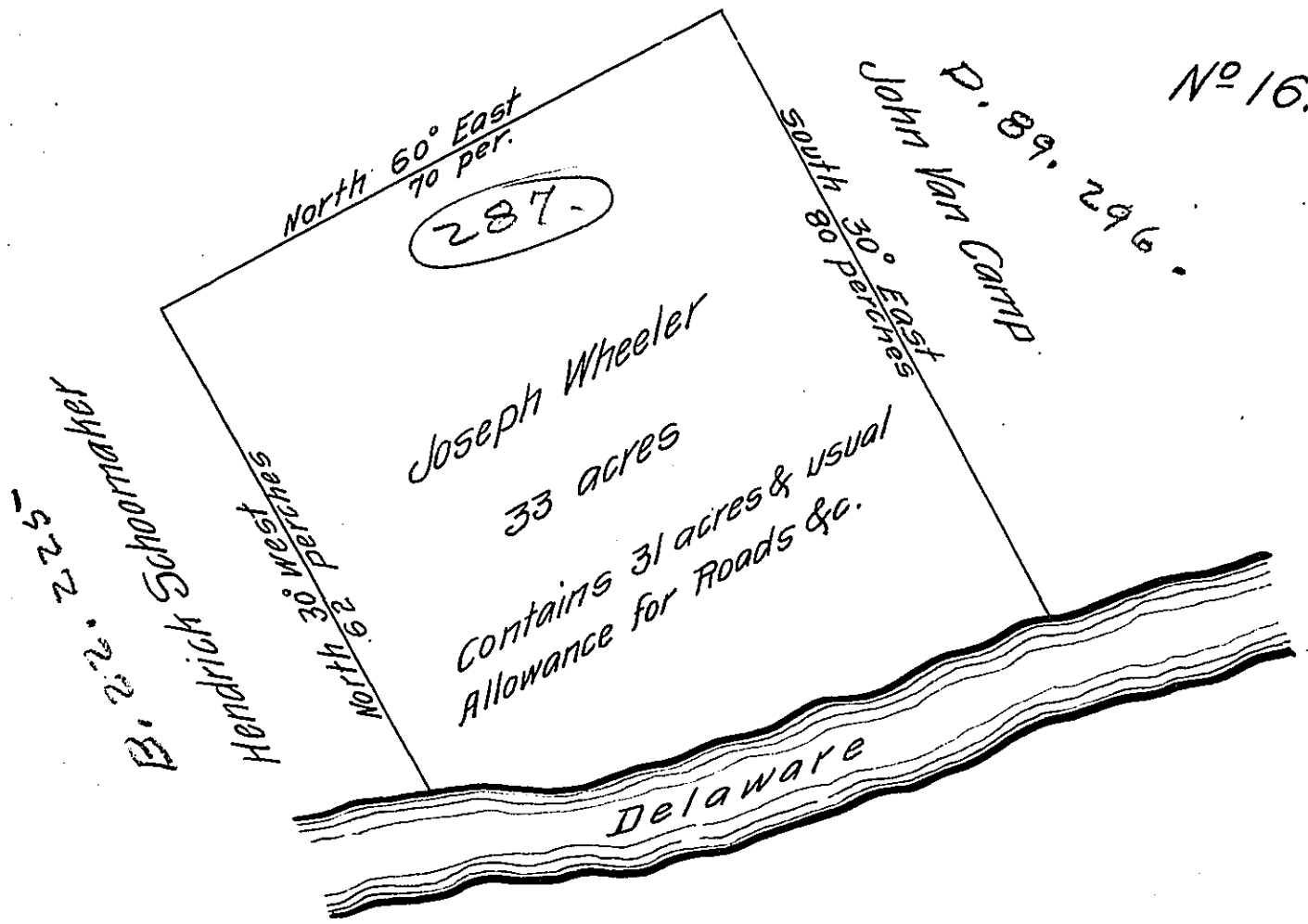

The Draught of a Tract of land situate near the Minnesink in the County of Bucks Containing thirty three acres for William Allen of Philadelphia Esq^r by virtue of a warrant from the Proprietary Trustees Dated the 16th day of November 1727 for surveying to William Penn the Proprietary's Grandson ten thousand acres of land in this Province the right whereof is now vested in the said William Allen

Surveyed in July 1730.

Jacob Taylor —

IN TESTIMONY that the above is a copy of the original remaining on file in the Department of Internal Affairs of Pennsylvania, made conformably to an Act of Assembly approved the 16th day of February, 1833, I have hereunto set my Hand and caused the Seal of said Department to be affixed, at Harrisburg, this twenty-second day of July 190.

Henry Houch

Secretary of Internal Affairs.